

REVISIONS		
REV. NO.	DESCRIPTION	DATE
-	-	-

SUGGESTED SEQUENCE OF CONSTRUCTION

PHASE 1

1. THE CONTRACTOR SHALL CONSTRUCT TEMPORARY WIDENING ALONG THE SOUTH SIDE OF TEXANNA ROAD AND ALONG THE EAST SIDE OF EW-114.
2. TEMPORARY 36" CGMPS SHALL BE INSTALLED WHERE NOTED TO FACILITATE DRAINAGE DURING CONSTRUCTION.

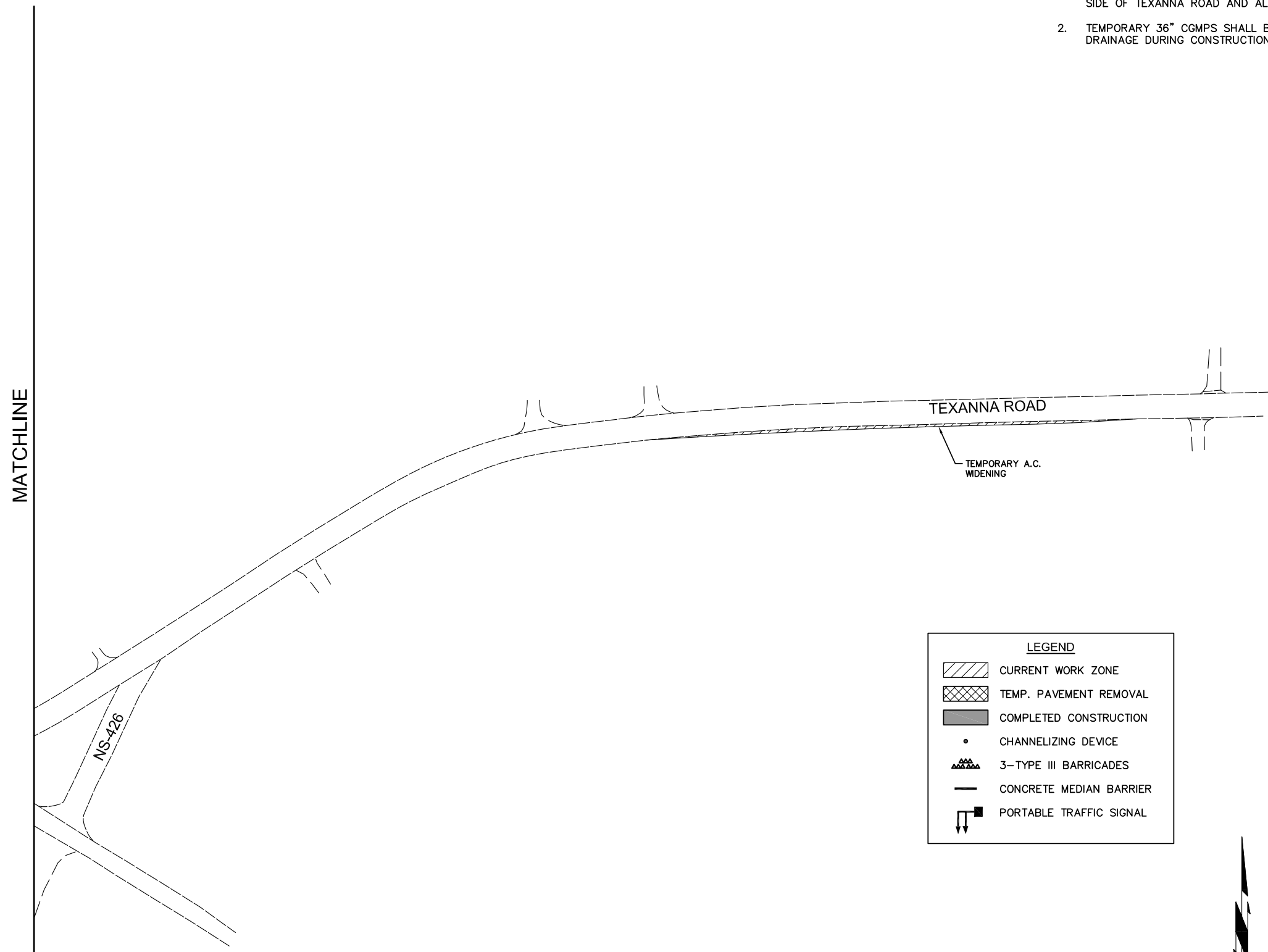

LEGEND	
	CURRENT WORK ZONE
	TEMP. PAVEMENT REMOVAL
	COMPLETED CONSTRUCTION
	CHANNELIZING DEVICE
	3-TYPE III BARRICADES
	CONCRETE MEDIAN BARRIER
	PORTABLE TRAFFIC SIGNAL

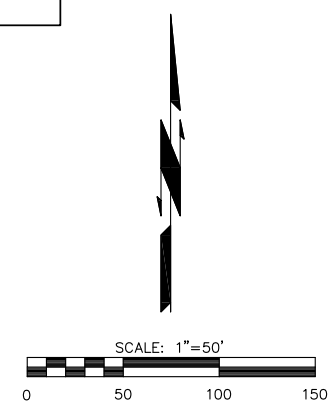

N:\AF34-CE02-1 - MCINTOSH-BROS\DRAWINGS\AF34-SEQUENCING.DWG - 8/11/2017

DESIGN		GCS		EW115 TEXANNA CREEK	MCINTOSH CO.
DRAWN		GLH		OKLAHOMA DEPARTMENT OF TRANSPORTATION	
CHECKED		GCS			
APPROVED				CONSTRUCTION SEQUENCING PHASE 1 (SHEET 2 OF 2)	
SQUAD		KCS		STATE JOB NO. 29374(04)	SHEET NO. T002